

**Xpert®**  
MRSA/SA  
SSTI

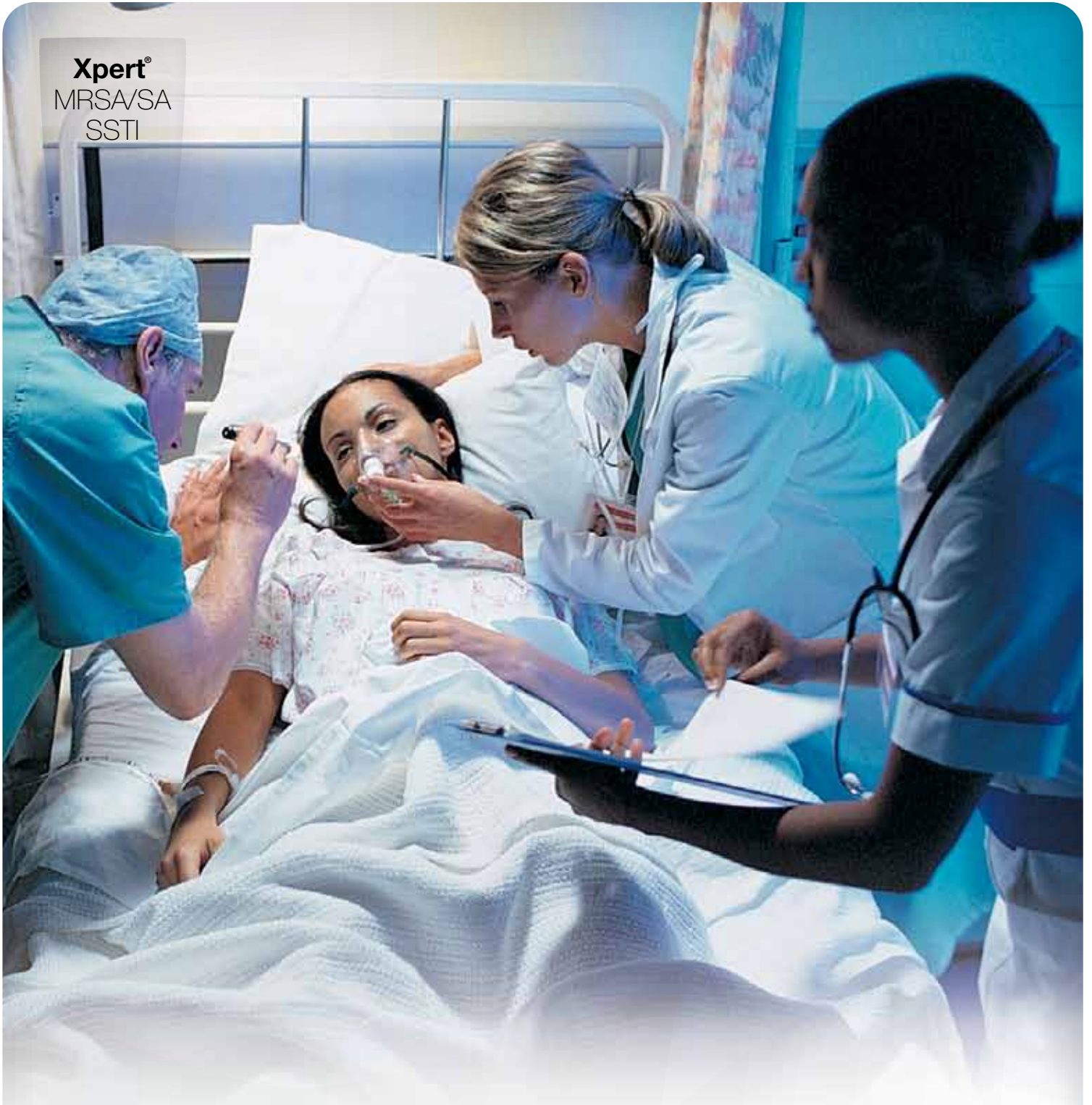

# Xpert® MRSA/SA SSTI

Detect MRSA & SA Skin and Soft Tissue Infections  
*In About One Hour*

CE IVD In Vitro Diagnostic Medical Device

 **Cepheid®**  
A better way.

“MRSA is the most common identifiable cause of skin and soft-tissue infection among patients presenting to emergency departments. When antimicrobial therapy is indicated for the treatment of skin and soft-tissue infections, clinicians should consider obtaining cultures and modifying empirical therapy to provide MRSA coverage.”



Moran, et al.  
New England Journal of Medicine, August 2006

## The Need

### SSTIs are a major health concern:

- The most common cause of skin and soft tissue infections is *Staph aureus*; MRSA represents over 50% of these infections in parts of the U.S.<sup>1</sup>
- Current laboratory methods can take up to 72 hours to determine if a SSTI is SA or MRSA
- Empiric treatment, found to be incorrect in 57% of patients according to one study, is employed due to lack of a rapid identification method<sup>2</sup>

## The Solution

### The only rapid and comprehensive SSTI test available:

- Xpert® MRSA/SA SSTI is a rapid, on-demand test for detecting MRSA and SA from skin and soft tissue swabs in less than one hour
- Xpert MRSA/SA SSTI is the most comprehensive *Staph aureus* test available:
  - Includes targets for *Staph aureus*, MRSA, and *mecA*
  - Identifies presumptive positive “empty cassette” strains for correct classification as SA sensitive
  - Unparalleled automation with the GeneXpert® System provides reduced hands-on time and improved laboratory efficiency

### Important healthcare benefits of rapid detection:

- Helps ensure the right therapy sooner for improved patient management
- Enables a targeted antimicrobial therapy approach for better antimicrobial stewardship
- Allows for immediate identification of patient infection for improved isolation and infection control measures

## Performance

Performance characteristics of Xpert® MRSA/SA SSTI were determined in a multi-site prospective investigation study at three institutions by comparing the Xpert MRSA/SA SSTI test on the GeneXpert® System to enriched culture, the most sensitive culture method.

### SUMMARY OF RESULTS

	Positive Percent Agreement	Negative Percent Agreement
MRSA	93.8%	97.3%
SA	95.7%	89.5%

### MRSA/SA PERFORMANCE IN SUBJECTS WITH NO ANTIBIOTIC USE (WITHIN 3 WEEKS OF SAMPLE COLLECTION) VS. REFERENCE CULTURE

		Culture			Totals
		MRSA+	SA+/MRSA-	Neg/No Growth	
Xpert	MRSA+	137 <sup>a</sup>	2	6	145
	SA+/MRSA-	3 <sup>b</sup>	79	16	98
	SA-	6	4	188	198
	Total	146	85	210	441

<sup>a</sup> 1 of the 137 were mixed infections of MRSA and SA.

<sup>b</sup> 2 of the 3 were mixed infections of MRSA and SA.

## Comprehensive

Capable of detecting strains with all SCCmec types found in both healthcare-acquired and community-acquired MRSA.

	Type
Samples	Swabs collected for routine care of SSTIs
SCCmec	I, II, III, IVa, V, VI

# Simplicity. Xpert<sup>®</sup> MRSA/SA SSTI

- Rapid results to improve patient management
- Fully integrated reagent and instrument system for accuracy and reproducibility
- Random access for flexibility and workflow optimization
- Fully automated process reduces handling time to just minutes

## WORKFLOW:

### 3 Easy Steps

Total hands-on time: 2 Minutes

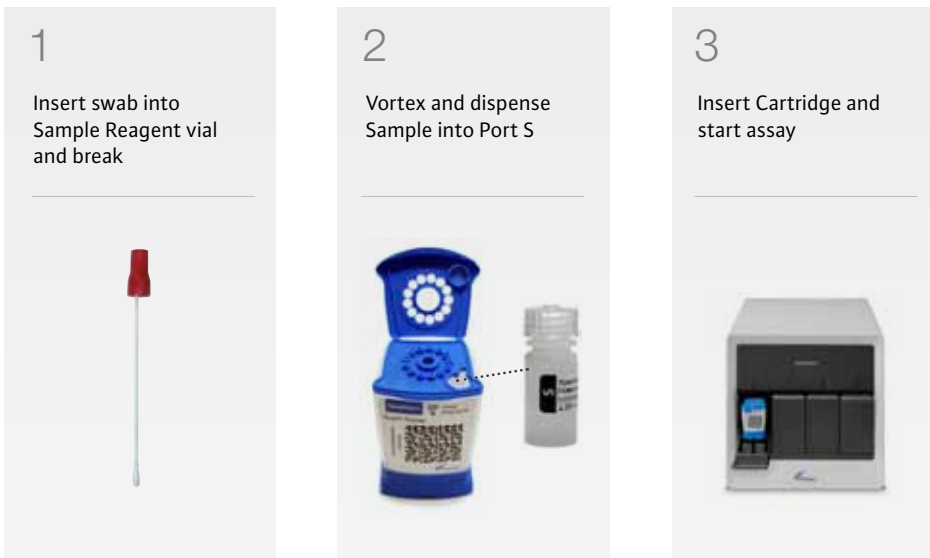

## ORDERING INFORMATION

Xpert<sup>®</sup> MRSA/SA SSTI (10 cartridges with reagents).....Catalog No. GXM RSA/SA-SSTI-10

### References:

1. CDC Press release 09/08/2008 entitled "CDC Steps Up Efforts to Fight Drug-Resistant Germ".
2. Moran et al. "Methicillin-Resistant *S. aureus* Infections among Patients in the Emergency Department", NEJM 355:664-674; 2006.



#### CORPORATE HEADQUARTERS

904 Caribbean Drive  
Sunnyvale, CA 94089 USA

TOLL FREE +1.888.336.2743  
PHONE +1.408.541.4191  
FAX +1.408.541.4192

#### EUROPEAN HEADQUARTERS

Vira Soleih  
81470 Maurens-Scopont, France

PHONE +33.563.82.53.00  
FAX +33.563.82.53.01

#### DIRECT SALES OFFICES

[www.Cepheidinternational.com](http://www.Cepheidinternational.com)

UK:  
+44 1494 616085 [sales@cepheideurope.co.uk](mailto:sales@cepheideurope.co.uk)  
France:  
+33 563 82 53 00 [cepheid@cepheideurope.fr](mailto:cepheid@cepheideurope.fr)  
Benelux:  
+31 55 526 39 30 [info@cepheidbenelux.com](mailto:info@cepheidbenelux.com)  
+32 14 713 913



THE PURCHASE OF THIS PRODUCT ALLOWS THE PURCHASER TO USE IT FOR THE PERFORMANCE OF DIAGNOSTIC SERVICES FOR HUMAN IN VITRO DIAGNOSTICS. NO GENERAL PATENT OR OTHER LICENSE OF ANY KIND OTHER THAN THIS SPECIFIC RIGHT OF USE FROM PURCHASE IS GRANTED HEREBY. NO OTHER RIGHTS ARE CONVEYED EXPRESSLY, BY IMPLICATION OR ESTOPPEL TO ANY OTHER PATENTS. FURTHERMORE, NO RIGHTS FOR RESALE ARE CONFERRED WITH THE PURCHASE OF THIS PRODUCT.